

## The Orient Dahabeya

The Orient is based on the design of an original Dahabiya from the late 18th and early 19th century and is built in colonial style. The heart of this traditional two-masted sailing boat is the half-shaded sundeck. It's the perfect place to lie in a wooden deck chair and lazily watch the landscape gliding by. Down below is a nice living area, a salon, four cabins and one suite. The cosy salon has a small library with books about the Nile and Egypt. With its comfortable sofas, it's the perfect setting to end the day. Swap stories, share experiences, read a book or play a game of backgammon while enjoying a Turkish coffee or a glass of Alexandrian wine.

The Orient is the smallest boat in our fleet. Accommodation aboard consists of four double cabins and just one suite with a private terrace. The beautifully appointed cabins and suite offer the charm of a bygone era. The boat is air-conditioned throughout and each cabin and the suite have an en-suite bathroom.

### 4 Luxury Cabins - Great views, inside and out

The four cabins are roomy at 17 square meters. Individually decorated with local antiques, every cabin has two large antique beds or one king-size bed dressed up with fine Egyptian cotton. Two large windows with Louvre shutters offer views of ancient sites, riverside villages and breathtaking scenery. Each of the air-conditioned cabins has a well-equipped bathroom with a bath, shower, toilet and a beautifully tiled floor.

### 1 Terrace Suite - Sleeping beauty & a private balcony

Dahabiya The Orient is fitted with one spacious suite with a private terrace. Located at the back of the boat, the terrace offers incredible views of the Nile. It's a lovely spot to relax and unwind after sightseeing ashore. The suite has a large antique double bed and is charmingly furnished with regional fabrics and furniture. Its private bathroom has a bath, shower and toilet.

### Deck Plan The Orient - Small boat, big adventures

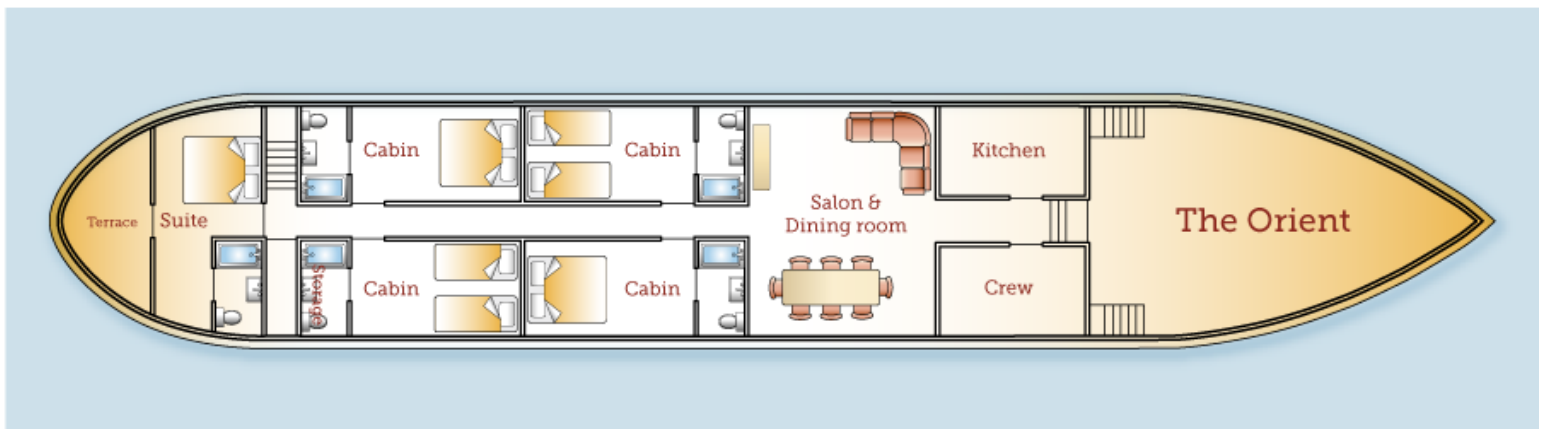

Length: 36.5 metres

Width: 6.5 metres

Passengers: 10

Crew: 10

4 Twin Cabins, 17 square meters in size, each with private bathroom

1 Double Suite, 26 square meters in size, with private bathroom and terrace

1 Salon & Dining room

- All cabins and the suite outside-facing with panoramic windows
- Each of the cabins and the suite has a private en suite bathroom with a bath, shower and a toilet
- The boat is air-conditioned throughout with individual controls
- Complimentary Wifi access is offered throughout the boat - Fair Usage Policy
- Generator for electricity
- Water filters for fresh water supply
- Waste water recycling and sewage treatment system
- Safety equipment (smoke detectors, emergency lighting and sprinkler system)